

10ft Sasha Alpine  
Log Cabin Shed  
Double Door Range  
Technical Details<sup>©</sup>



For Queries and Help  
please call Product  
Support:  
01636 858377

**BILLYOH**

Creating a garden lifestyle...

In association with



**PROPRIETARY AND CONFIDENTIALITY**

All the information contained within this document including all technical data, dimensions, shape/form and branding (inc. Trademarks, logos, etc.) Is the sole property of Kybotech Limited. The reproduction and/or disclosure to any third party of any information contained within this document is strictly prohibited. Breaches of the copyright will be dealt with on the highest level of severity with immediate legal proceedings.

# 10ft Sasha Alpine Log Cabin Shed Double Door Range

Front elevation: width 3.257m/10'8" available in standard 19mm & 28mm cladding types

Sizes available

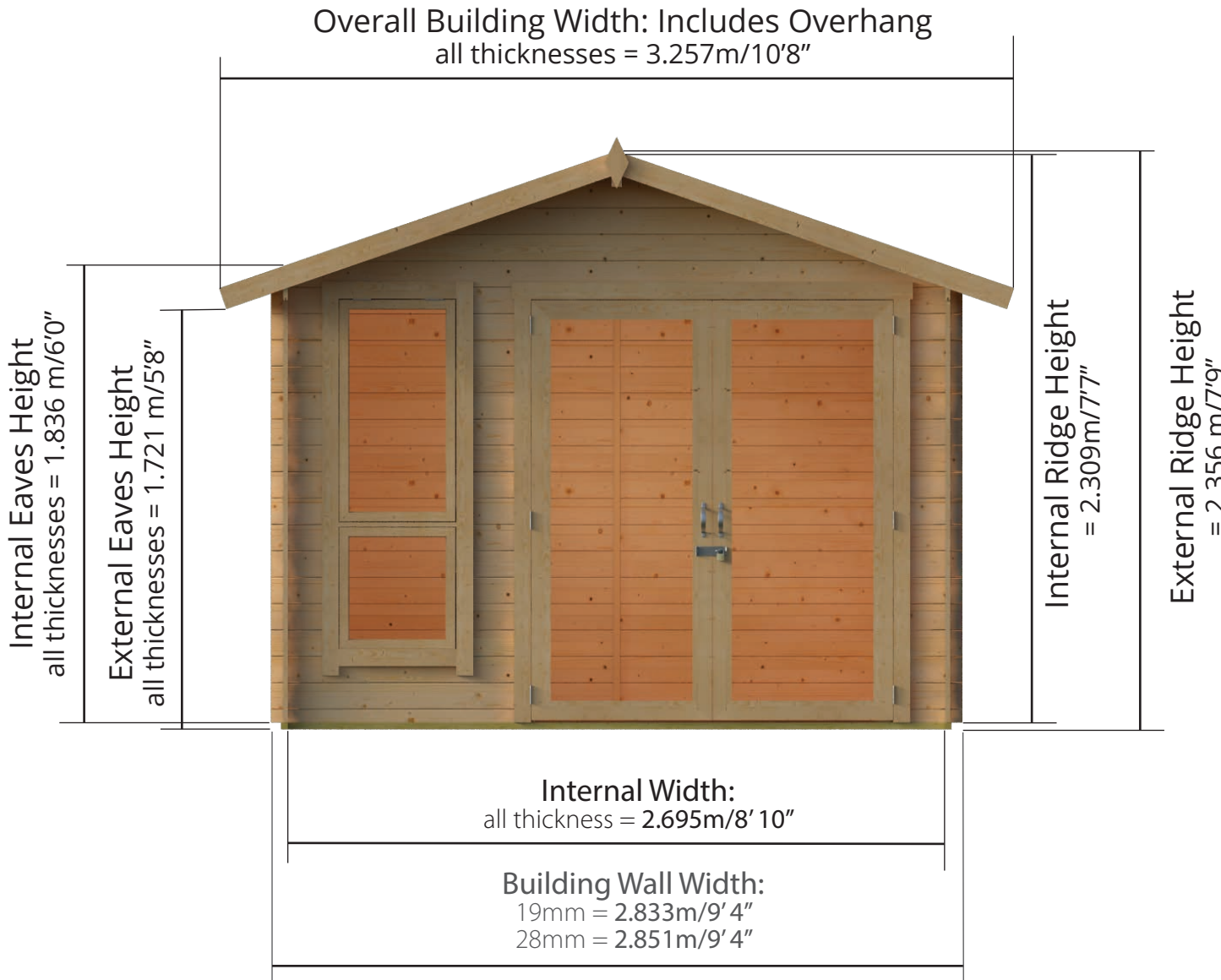

Alpine Log Cabin Shed  
W10ft x D14ft  
(Including Overhang)



Alpine Log Cabin Shed  
W10ft x D12ft  
(Including Overhang)



Alpine Log Cabin Shed  
W10ft x D10ft  
(Including Overhang)



Alpine Log Cabin Shed  
W8ft x D10ft  
(Including Overhang)

W3.257m x D4.417m / W14'6" x D10' 8"

# Interlocking Windowed Shed:

## Side elevation

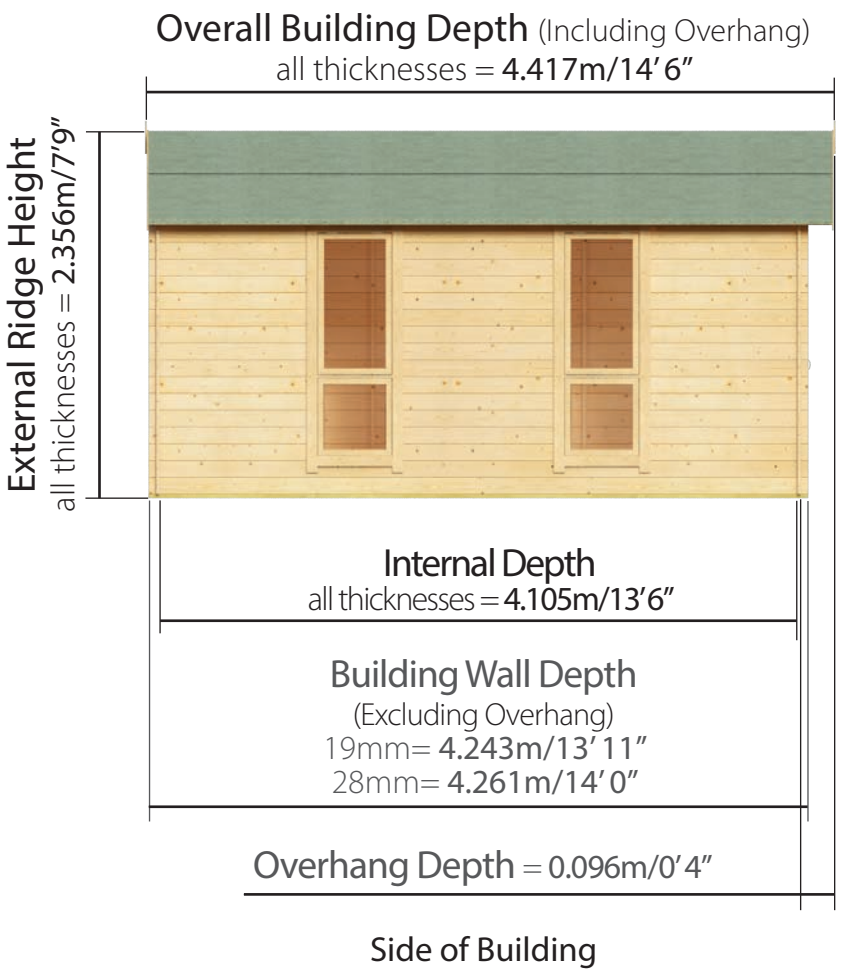

## Floor Plan

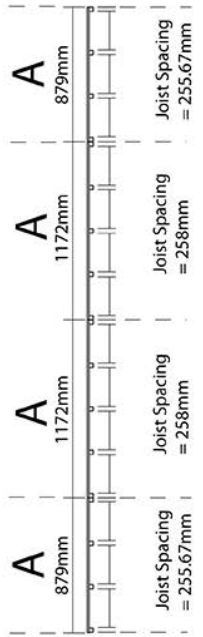
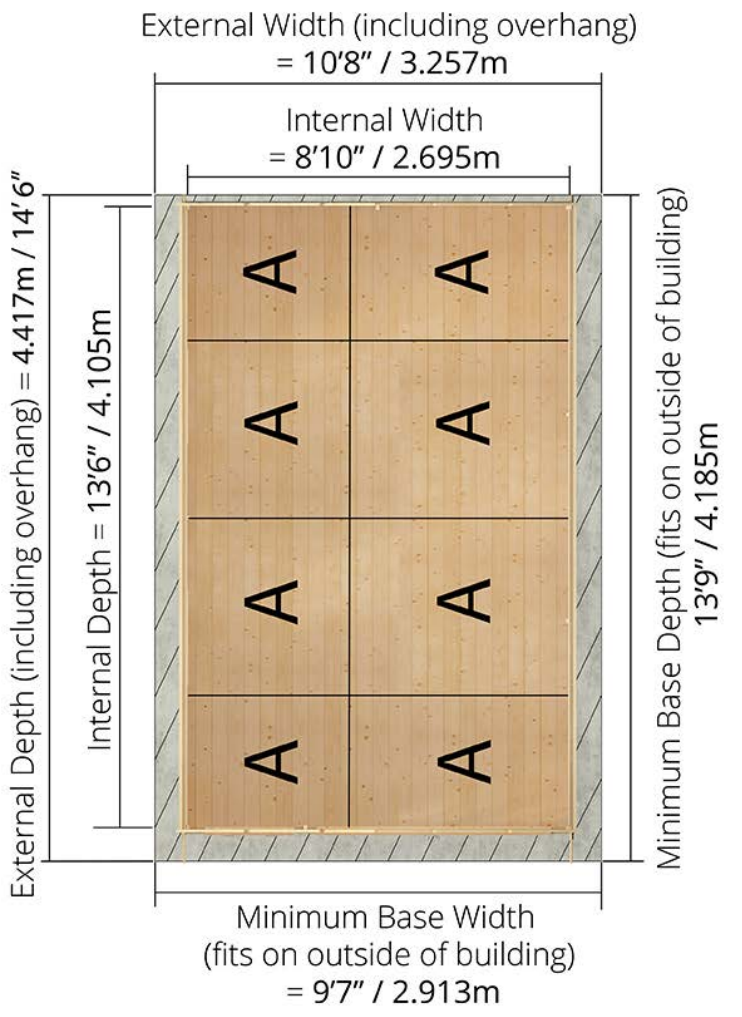

Floor Profile



Roof Overhang Area

Please note: your base must be perfectly level and drainage is required to allow water to run off the surface. There must also be at least 2m clearance on each side to allow annual treatment to be applied.

W3.257m x D3.831m / W10'8" x D12'7"

Interlocking Windowed Shed:

Side elevation

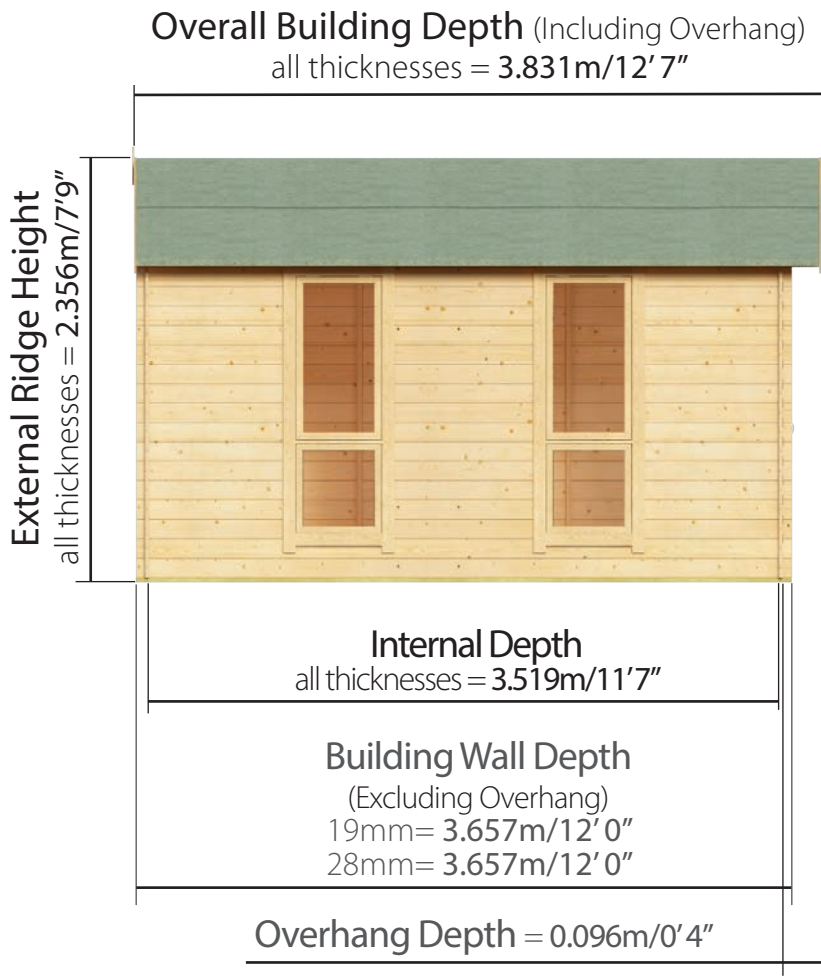

Side of Building

Floor Plan

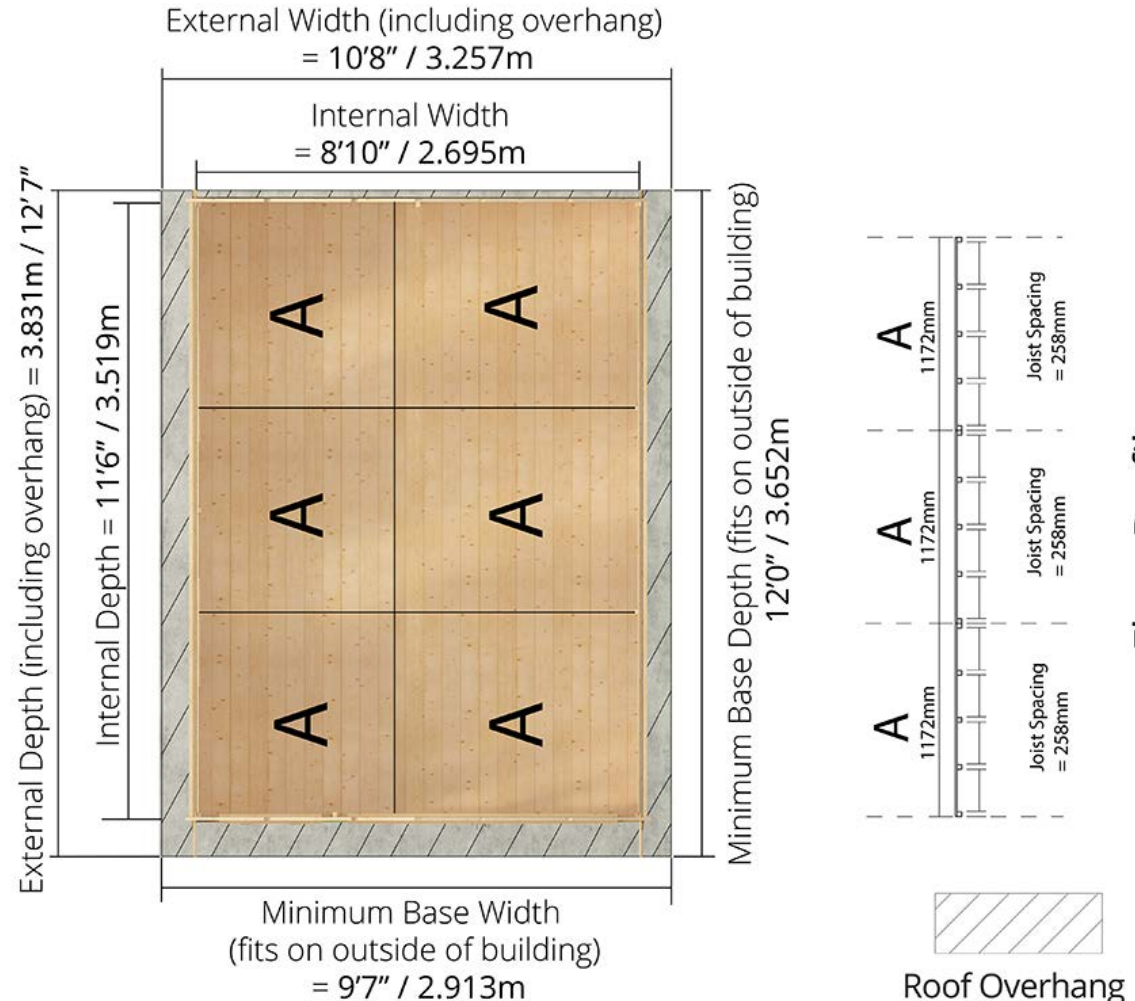

Please note: your base must be perfectly level and drainage is required to allow water to run off the surface. There must also be at least 2m clearance on each side to allow annual treatment to be applied.

W3.257m x D3.267m / W10'8" x D10'9"

# Interlocking Windowed Shed:

## Side elevation

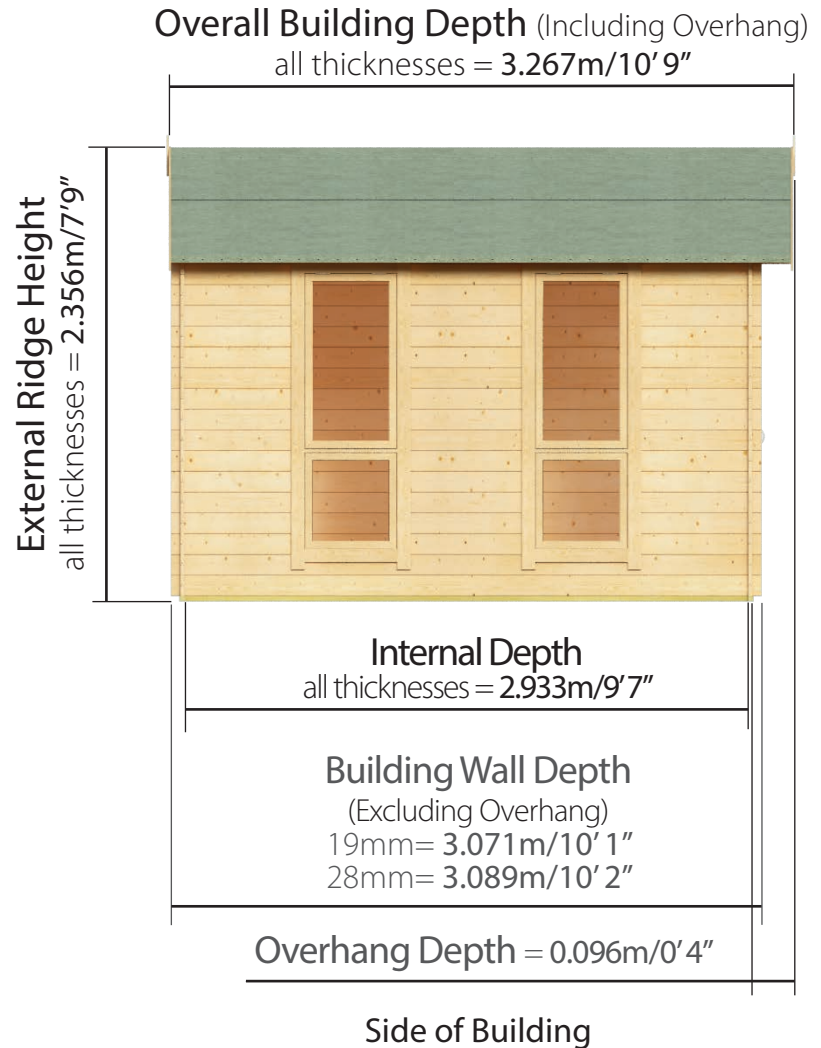

## Floor Plan

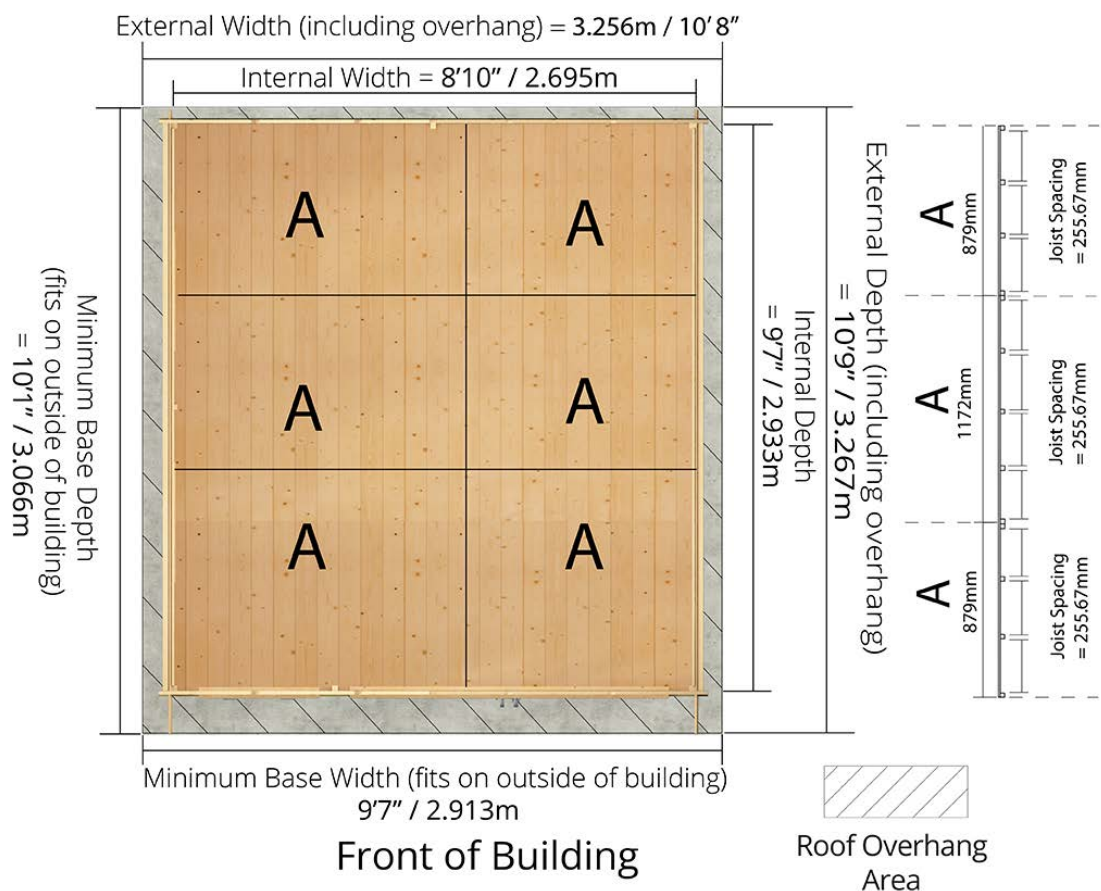

Please note: your base must be perfectly level and drainage is required to allow water to run off the surface. There must also be at least 2m clearance on each side to allow annual treatment to be applied.

# W3.257m x D2.388m / W10'8" x D7'10"

## Interlocking Windowed Shed:

### Side elevation

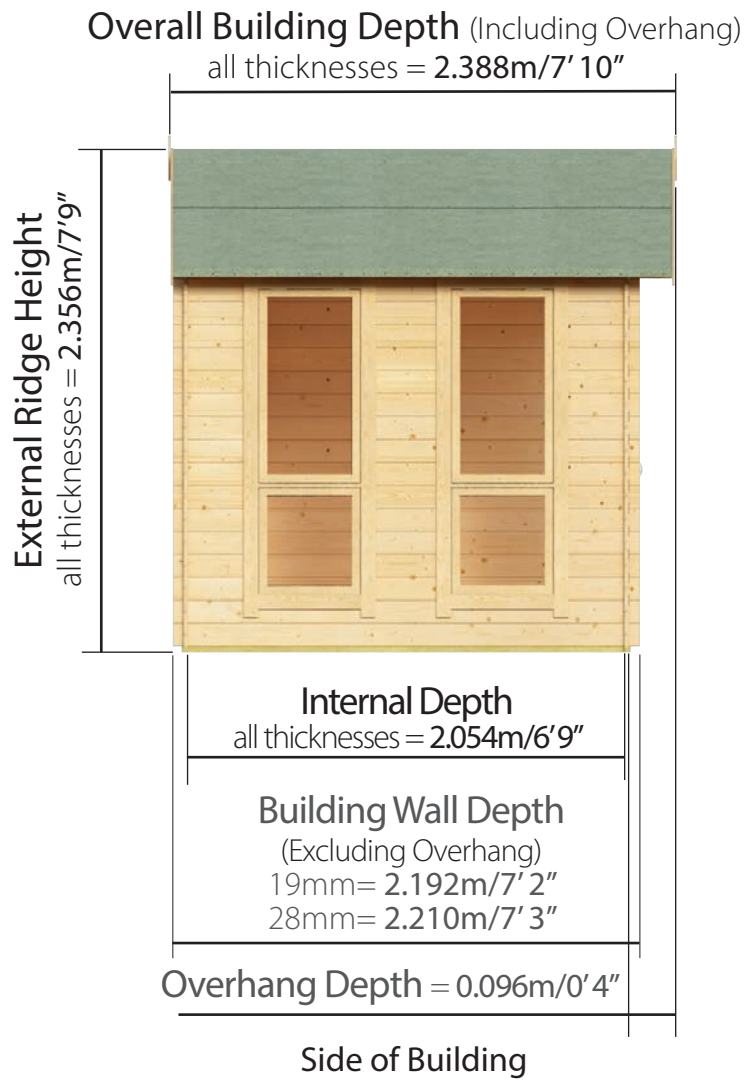

### Floor Plan

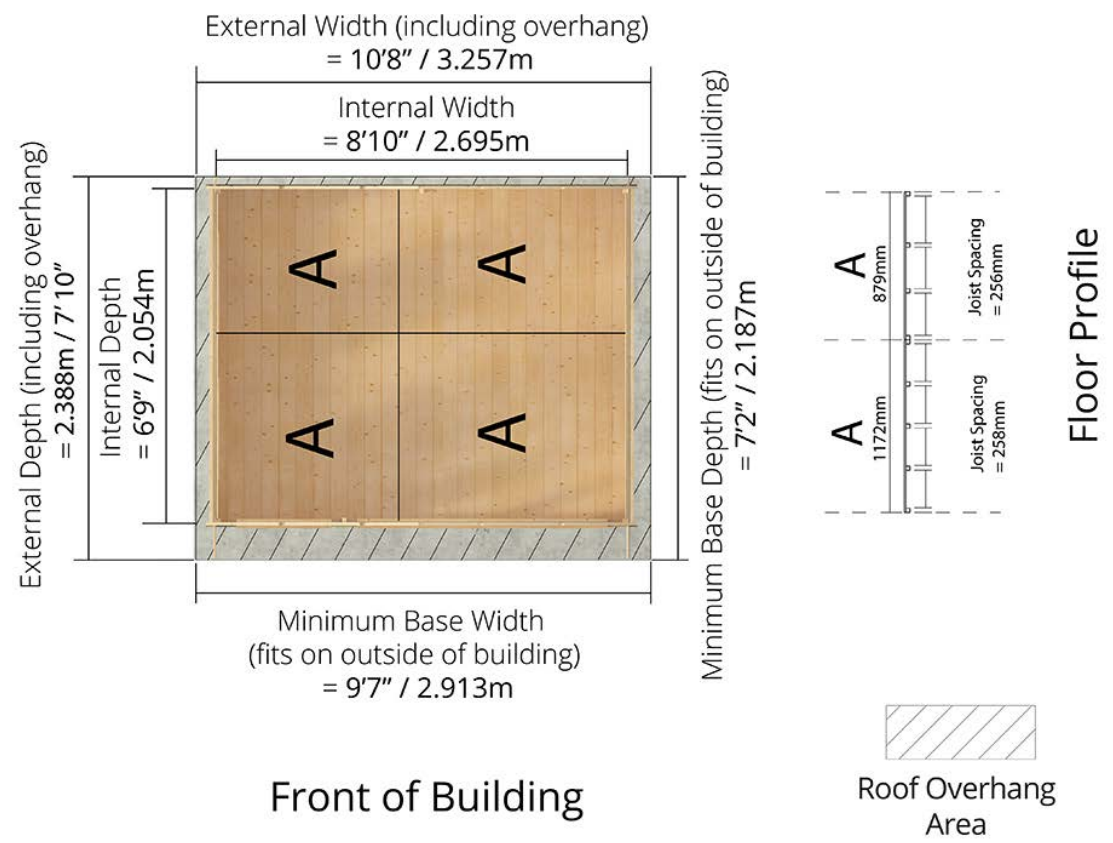

Please note: your base must be perfectly level and drainage is required to allow water to run off the surface. There must also be at least 2m clearance on each side to allow annual treatment to be applied.